

OPTICAL EXTREME™ SERIES:
Outdoor Ultra-High Protection, IP66 Rated
Sunlight Readable LED Wall Solutions



Powered By:



Contact us: Innovative Controls Company
sales@icc-co.com | 248-707-0774 | www.icc-co.com

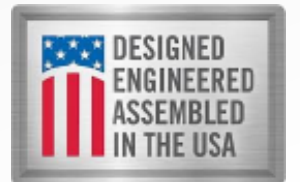



APPLICATIONS:



- ◆ Gas Stations
- ◆ Outdoor Retail LED Signage
- ◆ Amusement Parks / Sports Arenas / Stadiums / Concerts
- ◆ Transportation (Airports, Railway, Border Protection, Truck Quarries, Highway / Interstate Signage)
- ◆ Hospitality & Casinos
- ◆ Industrial / Manufacturing Plants

Contact us: Innovative Controls Company
sales@icc-co.com | 248-707-0774 | www.icc-co.com

◆ EXTREME OUTDOOR RATED SPECS:



- ✓ IP66 Waterproof
- ✓ Die-Cast Aluminum Housing
- ✓ Fire Rating up to 5VB
- ✓ Self Contained Heat Dissipation
- ✓ 9000 NITS ULTRA BRIGHT
- ✓ -40° to 60° Celsius Operating Temp



◆ Integrated box = NO COMPLEX WIRING
like traditional LED wall manufacturers

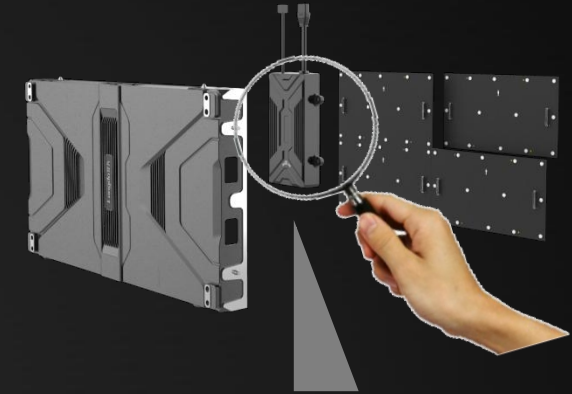
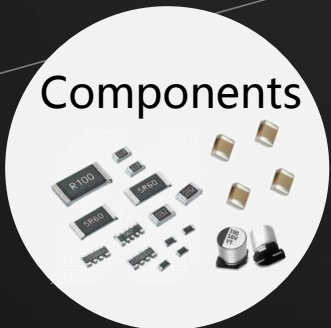
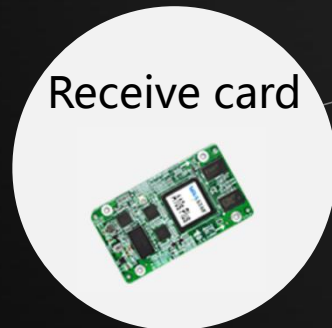
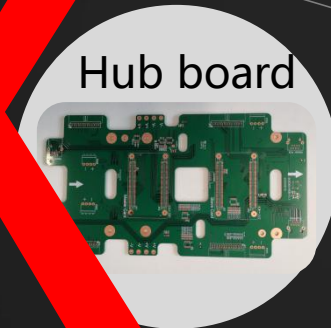
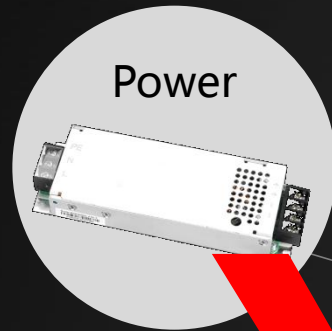

ICC
Simplified



◆ Optical Extreme™: Highlighted Specifications



Specification Details					
Pixel Pitch	3.9mm	4.8mm	5.9mm	8.3mm	10.4mm
Module Size	500 mm * 250 mm				
Module Resolution (dots)	128 x 64	104 x 52	84 x 42	60 x 30	48 x 24
Cabinet Resolution (dots)	640 x 360	480 x 270	384 x 216	320 x 180	240 x 135
Cabinet Size (WxHxD) (mm)	1000 x 500 / 1000 x 750 / 1000 x 1000				
Cabinet Weight	27 kg/m ²				
Maintenance	Front & Rear Serviceable				
Brightness	9000 NITS Max (Adjustable)				
Refresh Rate	3840 Hz				
Viewing Angle	178° Horizontal and Vertical				
Voltage	110-240 VAC (50-60Hz)				
Max Power Consumption	550 W / m ²				
Average Power Consumption	165 Watts / m ²				
MTBF (Life Span to Half Brightness)	150,000 Hours				
Operating Temperature	(-40° to 60° Celsius (-40° to 140° Fahrenheit))				
Outdoor Rating	IP66 Waterproof, Fire Rating up to 5VB				
Control System	Novastar (HDMI, DVI, SDI Inputs)				

● Features

◆ Visual Performance

- Crisp & Clear Videos/Images & Text
- 16:9 Standard Display Ratio



◆ Extreme™ LED series

Pitch Sizes 3.9 / 4.8 / 5.9 / 8.3 / 10.4 mm

Blinding Bright - Adjustable LED's up to 9000 NITS

Great Quality Images Rated for Extreme Conditions



● Unique Features



◆ Easy after-sale service

Front & Rear Maintenance :

Easy to maintain no matter
whether mounted against a wall
or up high on a pole!

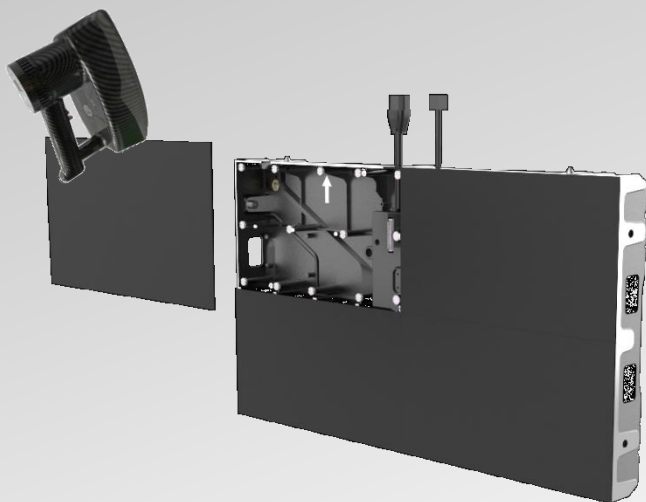

◆ Easy to Display Content for non-technical End-users

- Send Preset Scenes/Layouts using ICC's CAYFIT™ LED Wall Tablet thru WiFi or LAN direct to Novastar Controller*
- Change Advertisement, Message, or Video in seconds with patented LED CAYFIT™ software

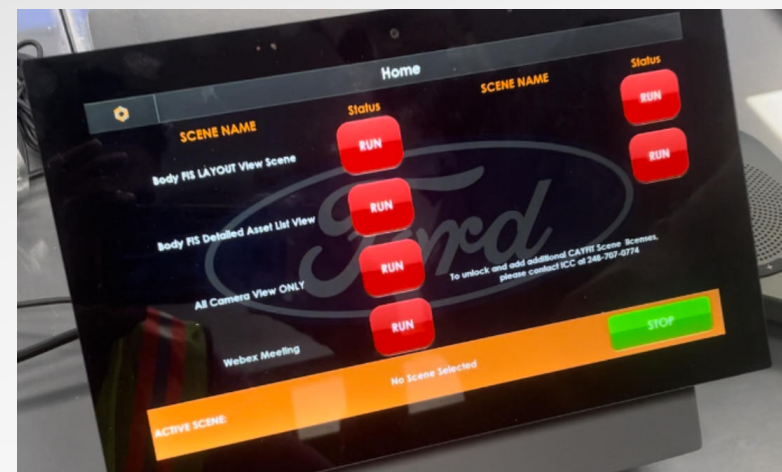

* CAYFIT Tablet and Software are optional feature add-ons and sold separately from LED wall

◆ Convenient install and use

2 people can complete installation of 1 Led screen in 1 hour

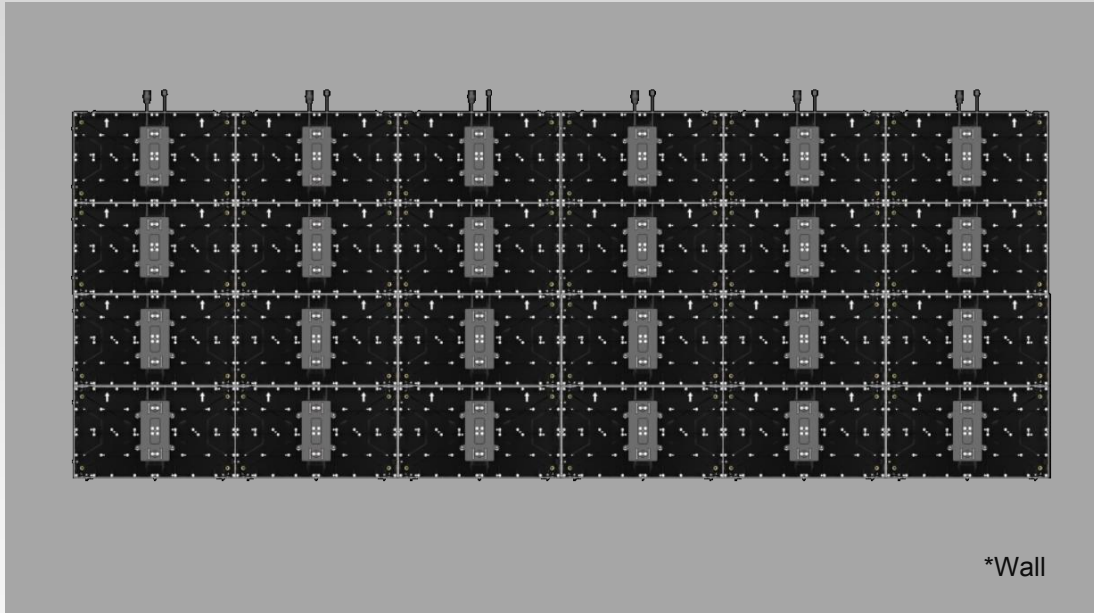

① Install the cabinets

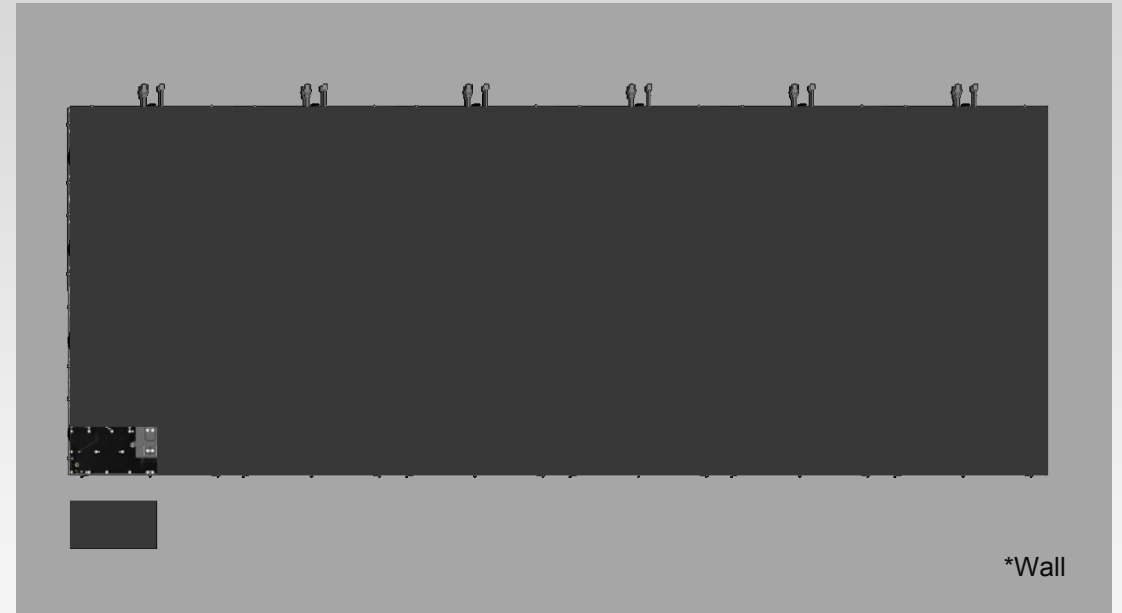

② Install the Led modules

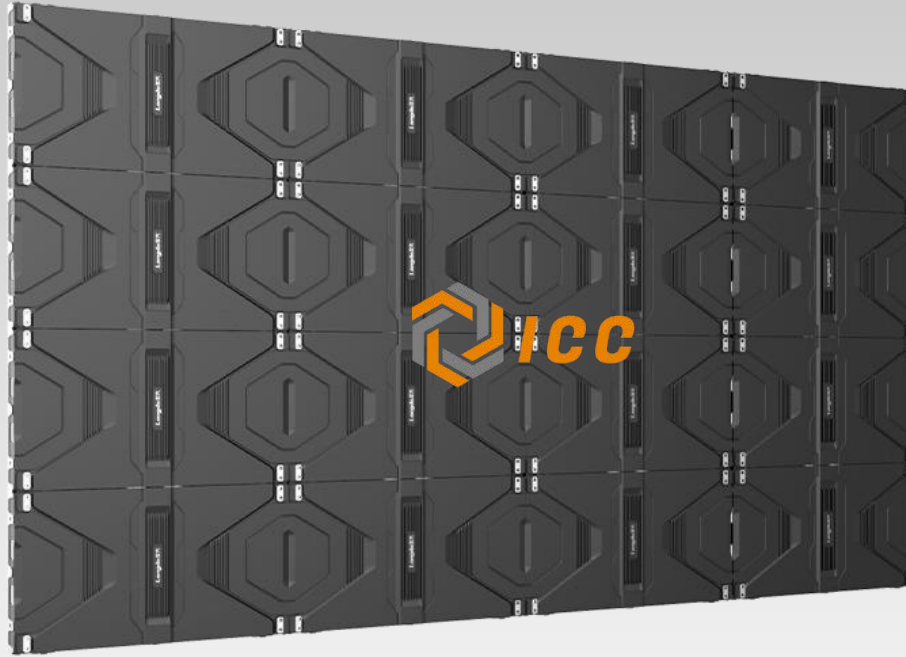

Contact ICC Application Engineering Department for more
Details, Customized Solutions and Pricing

sales@icc-co.com | www.icc-co.com | 248-707-0774 | 630-660-5681

